

# AURA 6,7,8,10,11

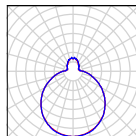
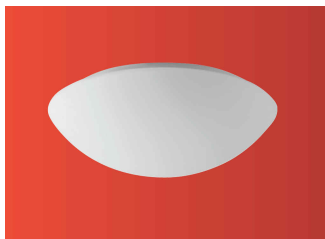

**TECHNICAL DATA**

Light source	LED module Osmont L11B, L12B, L12C, L15C, L16C, L18C	incandescent lamp
Chromacity temperature	3000K, 4000K	by source
CRI	3000K Ra>80, 4000K Ra>80	by source
Power source	Tridonic	-
Lifetime of LED	50 000 hod / L80B10 (ambient temperature 25°C)	by source
Energy class	A++	by source
Photobiological safety of lamps by EN 62471 (Blue light hazard)	safe (Risk group – 0)	by source
Input voltage	230V	
IP	IP44	
Ambient temperature	from -20°C to +30°C	
Warranty	5 years	
Fixture	metal	
Color of fixture	white	
Shade	three layers glass with matt surface	
Shade attachment	bayonet	
Mounting	wall, ceiling	
Applications	housing constructions (rooms, corridors), cultural premises	

**VARIANTS**

LED:

	Type	Input [W]	Luminous flux LED [lm]		Luminous flux of luminaire [lm]		Possibility		
			3000K	4000K	3000K	4000K	Sensor (HF)	DIM (DALI)	Corridor (DALI+HF)
AURA 6	LED-1L11B07BT11/011.000	8	1010	970	630	660	-	-	-
	LED-1L12C03BT12/012.000	9	1080	1140	700	740	*	*	-
AURA 7	LED-1L12B07BT12/012.000	11	1290	1350	840	880	*	*	-
	LED-1L18C02BT13/013.000	11	1450	1530	940	990	*	*	*
AURA 8	LED-1L18C03BT13/013.000	15	2000	2110	1360	1430	*	*	*
	LED-1L15C05BT14/014.000	15	2040	2150	1330	1400	*	*	*
AURA 10	LED-1L15C07BT14/014.000	21	2770	2920	1800	1900	*	*	*
	LED-1L16C05BT15/015.000	20	2720	2870	1770	1870	*	*	*
AURA 11	LED-1L16C07BT15/015.000	28	3690	3890	2400	2530	*	*	*

.000 – 3000K or 4000K

LED emergency and emergency combined:

	Type	Input [W]	Luminous flux LED [lm]		Luminous flux of luminaire [lm]		Luminous flux LED in emergency mode		T [hrs]	Type of battery
			3000K	4000K	3000K	4000K	[%]	[lm]		
AURA 6	LED-NZ1W/011 4000	1	-	170	-	110	100	170	1	LiFePO4 (3,2V/1,5Ah)
	LED-NZ1W/012 4000	1	-	150	-	100	100	150	3	Ni-Cd (3,6V/1,5Ah)
AURA 8	LED-1L18C02BT13/013/NK1W.000	11	1450	1530	940	990	10	150	3	Ni-Cd (3,6V/1,5Ah)
	LED-1L18C03BT13/013/NK1W.000	15	1950	2050	1260	1320	8	150	3	Ni-Cd (3,6V/1,5Ah)
AURA 10	LED-1L15C05BT14/014/NK1W.000	15	2040	2150	1330	1400	7	150	3	Ni-Cd (3,6V/1,5Ah)
	LED-1L15C07BT14/014/NK1W.000	21	2770	2920	1800	1900	6	150	3	Ni-Cd (3,6V/1,5Ah)
AURA 11	LED-1L16C05BT15/015/NK1W.000	20	2720	2870	1770	1870	5	150	3	Ni-Cd (3,6V/1,5Ah)
	LED-1L16C07BT15/015/NK1W.000	28	3690	3890	2400	2530	4	150	3	Ni-Cd (3,6V/1,5Ah)

.000 – 3000K or 4000K

STANDARD:

	Type	Input [W]	Socket	Possibility
				Sensor (HF)
AURA 6	IN-12BT11/011	60	E27	-
AURA 7	IN-12BT12/012	75	E27	-
AURA 8	IN-12BT13/013	100	E27	• (1x60W)
	IN-22BT13/013	2x60	2xE27	-
AURA 10	IN-12BT14/014	100	E27	• (1x75W)
	IN-22BT14/014	2x75	2xE27	-
AURA 11	IN-22BT15/015	2x75	2xE27	• (2x60W)

**BASE**  
FOR SIDE SUPPLY:

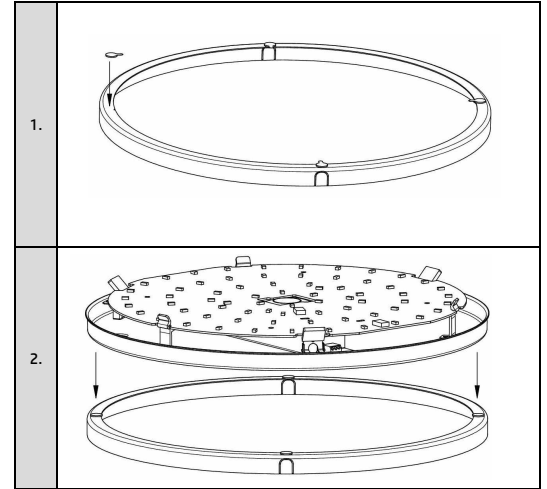
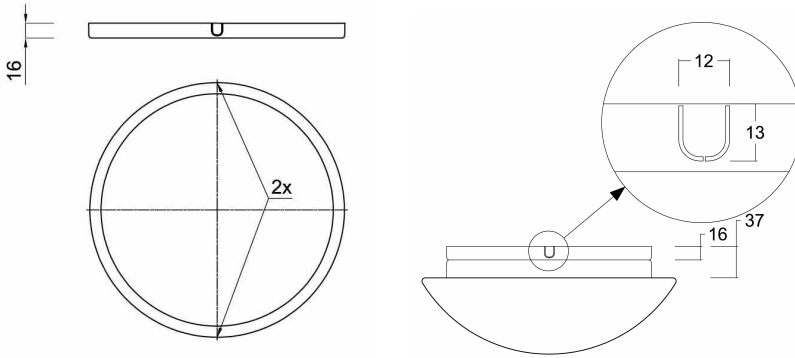

**DIMENSIONS**  
DIMENSIONS OF LUMINAIRE [mm]:

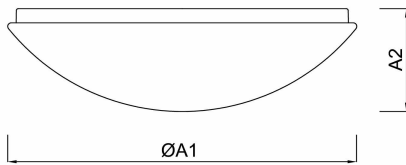

	ØA1	A2
AURA 6	200	105
AURA 7	250	110
AURA 8	300	115
AURA 10	360	125
AURA 11	420	125

MOUNTING DIMENSIONS [mm]:

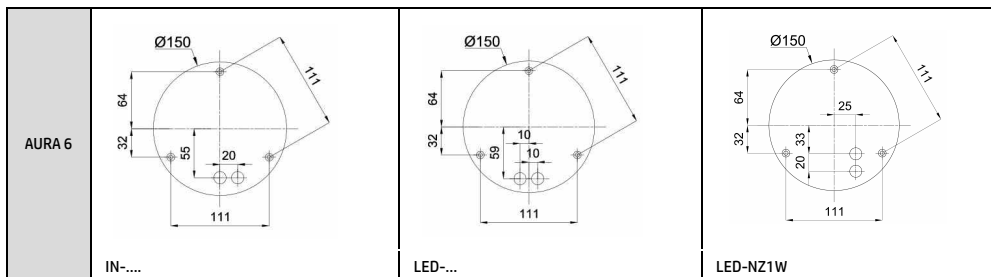

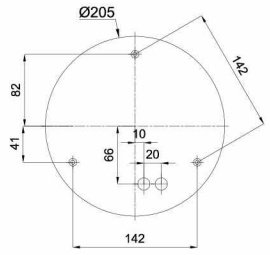
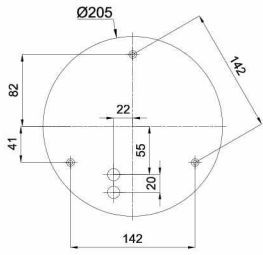
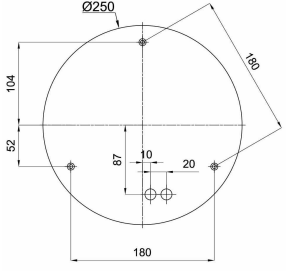
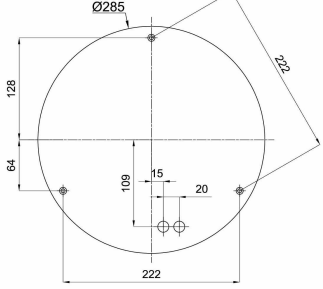
<p>AURA 7</p>	 <p>IN...</p>	 <p>LED...</p>
<p>AURA 8</p>		
<p>AURA 10</p>		
<p>AURA 11</p>	