

# AURA T5,T9

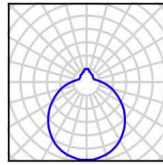

## TECHNICAL DATA

Light source	LED module Osmont L16B, L16C, L43C	incandescent lamp
Chromacity temperature	3000K, 4000K	by source
CRI	3000K Ra>80, 4000K Ra>80	by source
Power source	Tridonic	-
Energy class	A++	by source
Input voltage	230V	
IP	IP 41	
Pendant	1 steel wire + 3 steel wires connected in one lug and transparent supply cable lenght 1m	
Color of pendant	silver (S), black (C)	
Shade	three layers glass with matt surface	
Shade attachment	with folding holders	

## VARIANTS

LED:

	Type	Input [w]	Luminous flux LED [lm]		Luminous flux of luminaire [lm]		Possibility DIM (DALI)	Warranty [yrs]*
			3000K	4000K	3000K	4000K		
AURA T5	LED-1L16C07ZT86/082/L100 x .000	28	3690	3890	2550	2680	•	5
	LED-1L16B07ZT86/082/L100 x .000	36	4850	5070	3350	3500	•	5
AURA T9	LED-2L43C07ZT98/084/L100 x .000	37	5050	5330	3490	3680	•	5
	LED-2L43C10ZT98/084/L100 x .000	56	7250	7640	5000	5270	•	5

STANDARD:

	Type	Input [w]	Socket
AURA T5	IN-32ZT86/082/L100 x	3x60	3xE27
AURA T9	IN-32ZT98/084/L100 x	3x75	3xE27

.000 - 3000K or 4000K  
 x - color of pendant (S - silver, C - black)  
 \* - warranty on LED modules and power sources

## DIMENSIONS

DIMENSIONS OF LUMINAIRE [mm]:

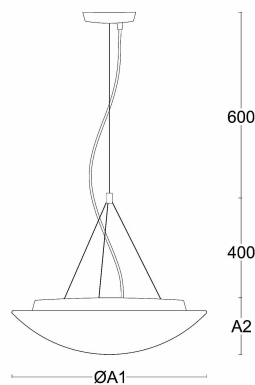

MOUNTING DIMENSIONS [mm]:

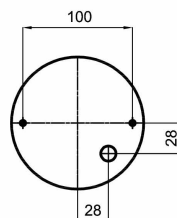

	ØA1	A2
AURA T5	490	140
AURA T9	590	140