

CARINA V1,V2

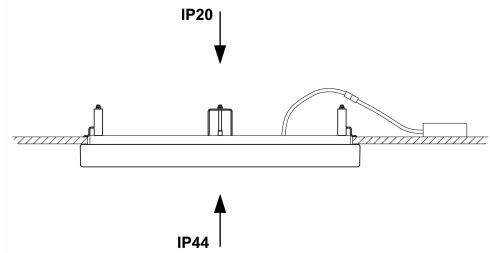
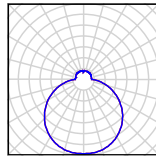

TECHNICAL DATA

Light source	LED module Osmont L17C, L20C
Chromaticity temperature	3000K, 4000K
CRI	3000K Ra>80, 4000K Ra>80
Power source	Tridonic
Lifetime of LED	50 000 hod / L80B10 (ambient temperature 25°C)
Energy class	A++
Photobiological safety of lamps by EN 62471 (Blue light hazard)	safe (Risk group – 0)
Input voltage	230V
IP	IP44
Ambient temperature	from -20°C to +30°C
Warranty	5 years
Fixture	metal
Color of fixture	white
Shade	three layers glass with matt surface
Shade attachment	with folding holders
Mounting	recessed
Applications	housing constructions (rooms, corridors), cultural premises

VARIANTS

LED:

	Type	Input [w]	Luminous flux LED [lm]		Luminous flux of luminaire [lm]		Possibility DIM (DALI)
			3000K	4000K	3000K	4000K	
CARINA V1	LED-1L17C07KNV76/425.000	25	3320	3500	2090	2210	•
CARINA V2	LED-1L20C07KNV96/426.000	35	4750	5010	3090	3260	•
	LED-1L20C10KNV96/426.000	50	6540	6890	4250	4480	•

.000 – 3000K or 4000K

DIMENSIONS

DIMENSIONS OF LUMINAIRE [mm]:

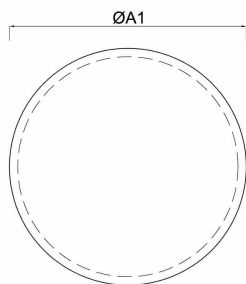

MOUNTING DIMENSIONS [mm]:

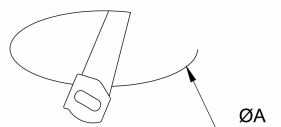

	ØA
CARINA V1	346
CARINA V2	470

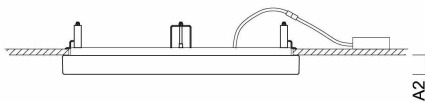

	ØA1	A2
CARINA V1	375	40
CARINA V2	500	40

