

SATURN L1,L2

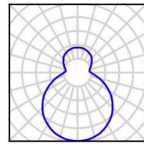

TECHNICAL DATA

Light source	LED module Osmont L61C, L62C	fluorescent lamp
Chromacity temperature	3000K, 4000K	by source
CRI	3000K Ra>80, 4000K Ra>80	by source
Power source	Tridonic	Tridonic
Energy class	A++	by source
Input voltage	230V	
IP	IP 20	
Pendant	3 stainless steel wire pendants with transparent supply cable	
Color of fixture	silver (S), black (C)	
Shade	three layers glass with matt surface	
Shade attachment	with folding holders	

VARIANTS

LED:

	Type	Input [W]	Luminous flux LED [lm]		Luminous flux of luminaire [lm]		Warranty [yrs] ⁺
			3000K	4000K	3000K	4000K	
SATURN L1	LED-1L61C03ZL11/462/L100 x .000	18	2270	2390	1540	1630	5
SATURN L2	LED-1L62C07ZL11/482/L100 x .000	33	4230	4460	2880	3030	5

STANDARD:

	Type	Input [W]	Socket	Type of lamp
SATURN L1	E-101ZL11 /462/L100 x	22	2GX13	T5c
SATURN L2	E-102ZL11 /482/L100 x	40	2GX13	T5c
	E-204ZL11/482/L100 x	22+40	2x2GX13	T5c

x – color (S – silver, C – black)

.000 – 3000K or 4000K

* – warranty on LED modules and power sources

DIMENSIONS

DIMENSIONS OF LUMINAIRE [mm]:

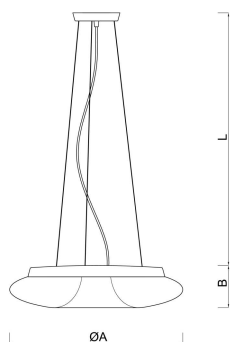

MOUNTING DIMENSIONS [mm]:

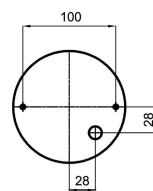

	ØA	B	L
SATURN 1	350	105	1000
SATURN 2	490	130	1000